

*Dear Parent:*

*Ever notice the look on your baby's face when they learn something new through their own discovery? These self-accomplished moments are a parent's greatest reward. To help fulfill them, VTech® created the **Smart Start**® series of toys.*

*These unique interactive learning toys directly respond to what children do naturally - play! Using innovative technology, these toys react to baby's interactions, making each play experience fun and unique as they learn age-appropriate concepts like first words, numbers, shapes, colors and music. More importantly, VTech®'s **Smart Start**® toys develop baby's mental and physical abilities by inspiring, engaging and teaching.*

*At VTech®, we know that a child has the ability to do great things. That's why all of our electronic learning products are uniquely designed to develop a child's mind and allow them to learn to the best of their ability. We thank you for trusting VTech® with the important job of helping your child learn and grow!*

*Sincerely,*

*Your Friends at VTech®*

*To learn more about **Smart Start**® and other VTech® toys, visit*

*[www.vtech.com](http://www.vtech.com)*

# INTRODUCTION

Thank you for purchasing the **VTech® Sort & Soar Rocket™** learning toy!

The **VTech® Sort & Soar Rocket™** learning toy is an interactive sorter toy for toddlers 9 months and up. Children can choose from six different activities. Drop the shapes in through the slots to watch the rocket come to life! When all five shapes are dropped into the rocket, watch it wobble back and forth and blast off!

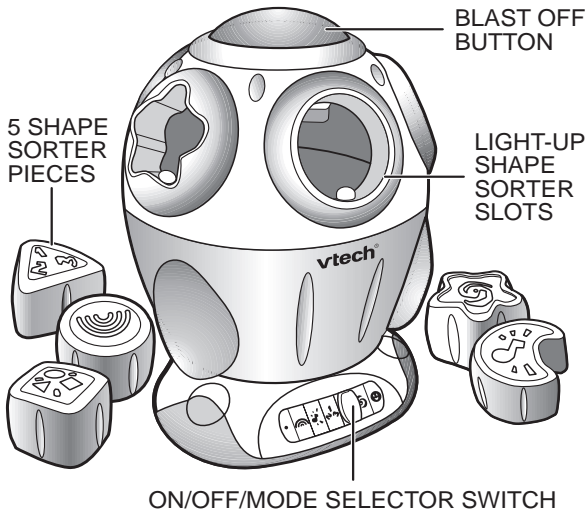

# INCLUDED IN THIS PACKAGE

- One VTech® Sort & Soar Rocket™ learning toy
- Five shape sorter pieces
- One instruction manual

**WARNING:** All packing materials, such as tape, plastic sheets, wire ties and tags are not part of this toy, and should be discarded for your child's safety.

## GETTING STARTED

### BATTERY INSTALLATION

1. Make sure the unit is turned **OFF**.
2. Locate the battery cover on the bottom of the unit. Use a screwdriver to loosen the screw.
3. Install 4 new "AA" (UM-3/LR6) batteries following the diagram inside the battery box. (The use of new alkaline batteries is recommended for maximum performance.)
4. Replace the battery cover and tighten the screw to secure the battery cover.

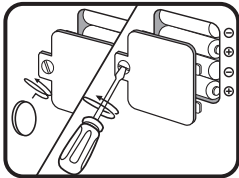

## BATTERY NOTICE

- Install batteries correctly observing the polarity ( +, - ) signs to avoid leakage.
- Do not mix old and new batteries.
- Do not use batteries of different types.
- Remove exhausted or new batteries from the equipment when the unit will not be used for an extended period of time.
- Do not dispose of batteries in fire.
- Do not attempt to recharge ordinary batteries.
- The supply terminals are not to be short-circuited.
- Only batteries of the same and equivalent type as recommended are to be used.

**WE DO NOT RECOMMEND THE USE OF RECHARGEABLE BATTERIES.**

# PRODUCT FEATURES

## 1. ON/OFF MODE SELECTOR SWITCH

To turn the unit **ON**, slide the **ON/OFF/MODE SELECTOR SWITCH** to select an activity. To turn the unit **OFF**, slide the **ON/OFF/MODE SELECTOR SWITCH** to the **OFF (●)** position.

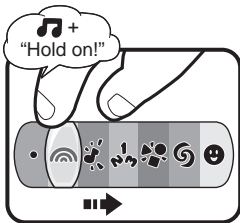

- ## 2. To adjust the volume, slide the VOLUME CONTROL SWITCH located on the bottom of the unit to the (🔊) position for **LOW VOLUME**, or to the (🔊🔊) position for **HIGH VOLUME**.

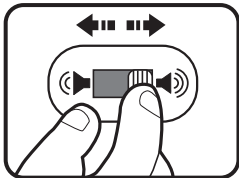

## 3. AUTOMATIC SHUT-OFF

To preserve battery life, the **VTech® Sort & Soar Rocket™** learning toy will automatically power-down after several minutes without input. The rocket can be turned on again by pressing any button.

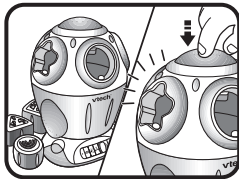

## 4. SIX MODES OF PLAY

The six modes of play include **Colors**, **Music**, **Counting**, **Shapes**, **Sounds** and **Free Play**. Slide the mode selector to select the mode.

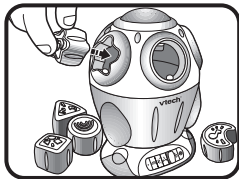

# ACTIVITIES

1. Slide the **ON/OFF MODE SELECTOR SWITCH** to select the mode. Insert the shape sorter pieces to hear responses based on the activity.

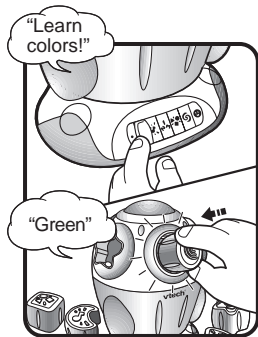
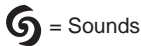
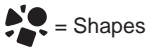
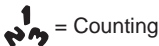
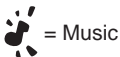
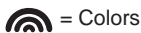

In the Free Play mode, the first shape sorter piece inserted automatically determines the mode of play. If there is no input into the rocket after a few seconds, you will hear a random mode introductory phrase.

2. When all five shapes have been inserted, you will hear a fun phrase and sound effects. The lights will flash and the rocket will wobble back and forth then blast off! The shapes will tumble out from inside the rocket.



3. Press the **BLAST OFF BUTTON** on the top of the rocket before the rocket has been popped up. You will hear one of three random responses. The lights will flash and the rocket will wobble back and forth then blast off! Press the **BLAST OFF BUTTON** when the rocket has been popped up. You will hear a fun melody. The lights will flash and the rocket will wobble back and forth.

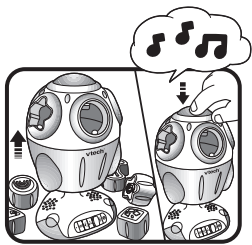
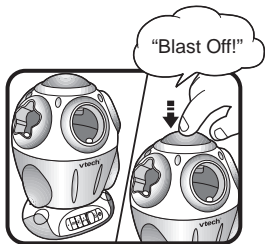

## MELODY LIST

1. Twinkle Twinkle Little Star
2. For He's a Jolly Good Fellow
3. Au Claire de la Lune
4. This Old Man
5. Pop! Goes the Weasel
6. Sing a Song of Sixpence

# CARE & MAINTENANCE

1. Keep the unit clean by wiping it with a slightly damp cloth.
2. Keep the unit out of direct sunlight and away from any direct heat source.
3. Remove the batteries when the unit is not in use for an extended period of time.
4. Do not drop the unit on hard surfaces and do not expose the unit to moisture or water.

# TROUBLESHOOTING

If for some reason the program/activity stops working, please follow these steps:

1. Please turn the unit **OFF**.
2. Interrupt the power supply by removing the batteries.
3. Let the unit stand for a few minutes, then replace the batteries.
4. Turn the unit **ON**. The unit should now be ready to play again.
5. If the product still does not work, replace with an entire set of new batteries.

If the problem persists, please call our Consumer Services Department at 1-800-521-2010 in the U.S. or 1-800-267-7377 in Canada, and a service representative will be happy to help you.

If you misplace any of the shape sorter pieces, you can contact our Consumer Services Department at 1-800-521-2010 in the U.S. or 1-800-267-7737 in Canada, and a service representative would be happy to replace them.

For information on this product warranty, please call **VTech**® at 1-800-521-2010 in the U.S. or 1-800-267-7377 in Canada.



## IMPORTANT NOTE:

Creating and developing **Smart Start**<sup>®</sup> products is accompanied by a responsibility that we at **VTech**<sup>®</sup> take very seriously. We make every effort to ensure the accuracy of the information, which forms the value of our products. However, errors sometimes can occur. It is important for you to know that we stand behind our products and encourage you to call our Consumer Services Department at 1-800-521-2010 in the U.S., or 1-800-267-7377 in Canada with any problems and/or suggestions that you might have. A service representative will be happy to help you.

### Note:

This equipment generates and uses radio frequency energy and if not installed and used properly, that is, in strict accordance with the manufacturer's instructions, it may cause interference to radio and television reception. It has been type tested and found to comply within the limits for a Class B computing device in accordance with the specifications in Sub-part J of Part 15 FCC Rules, which are designed to provide reasonable protection against such interference in a residential installation. However, there is no guarantee that interference will not occur in a particular installation. If this equipment does cause interference with radio or television reception, which can be determined by turning the equipment off and on, the user is encouraged to try to correct the interference by one or more of the following measures:

- Reorient the receiving antenna
- Relocate this product with respect to the receiver
- Move this product away from the receiver